

PHILLIPS COUNTY  
COUNTY ROADWAY OCCUPANCY AGREEMENT

AGREEMENT NUMBER \_\_\_\_\_

Underground Construction and Maintenance for \_\_\_\_\_  
(pipeline, waterline etc.)

Applicant

Address

Underground Construction of a \_\_\_\_\_ that will be across  
County Road \_\_\_\_\_ from Sec. \_\_\_\_\_ to Sec. \_\_\_\_\_, T \_\_\_\_\_ N, R \_\_\_\_\_ W.

(Include legal description of property crossing from and property crossing to and county roads being crossed).

1. All work shall be done in a workman like manner. The fill will be properly compacted and the road surface will be replaced to meet the existing surface conditions. The right-of-way shall be left in a condition satisfactory to the County Road Manager.
2. The Owner shall hold the County harmless from any damage that may result to said roadway because of the construction or maintenance of said \_\_\_\_\_ and also safeguard and protect adjacent property.
3. The County will assume no responsibility for damage to the \_\_\_\_\_ occasioned by County construction or maintenance operations.
4. The County will give the Owner sufficient notice of any proposed construction or maintenance work that is likely to expose the \_\_\_\_\_ in order that Owner can arrange to protect the service and avoid damage.
5. The County will be furnished an "as built" drawing of the completed project.
6. The Owner shall be responsible for providing proper signing and flagging during construction.
7. The Owner will be responsible for locating any other underground utilities in the area before placing this \_\_\_\_\_.
8. Expected project completion date: \_\_\_\_\_

\_\_\_\_\_  
Owner

\_\_\_\_\_  
Chairman of Board of Commissioners

\_\_\_\_\_  
Date

\_\_\_\_\_  
Date

**The attached project inspection report must be turned into the Administration office at project completion. Inspection by Phillips County Road & Bridge Manager will be the final approval.**

**Return this form to the Phillips County Administration Office after the project is complete**

**COUNTY ROAD OCCUPANCY AGREEMENT**

Phillips County is hereby notified that the Road Occupancy Agreement \_\_\_\_\_ approved  
on \_\_\_\_\_ is now completed and ready for inspection.

\_\_\_\_\_  
Owner Representative

\_\_\_\_\_  
Date

The Road Occupancy Agreement covered by and approved on \_\_\_\_\_

Has been inspected by the Phillips County Road and Bridge Manager.

- 1) Inspection Report: There are no additional requirements and final approval is given \_\_\_\_\_(initial)
- 2) The following additional items need to be completed before final approval is granted by the county:

\_\_\_\_\_  
\_\_\_\_\_  
\_\_\_\_\_  
\_\_\_\_\_  
\_\_\_\_\_  
\_\_\_\_\_

If the owner needs to perform additional work, this form will need to be re-submitted for review and approval.

\_\_\_\_\_  
Road and Bridge Manager

\_\_\_\_\_  
Date

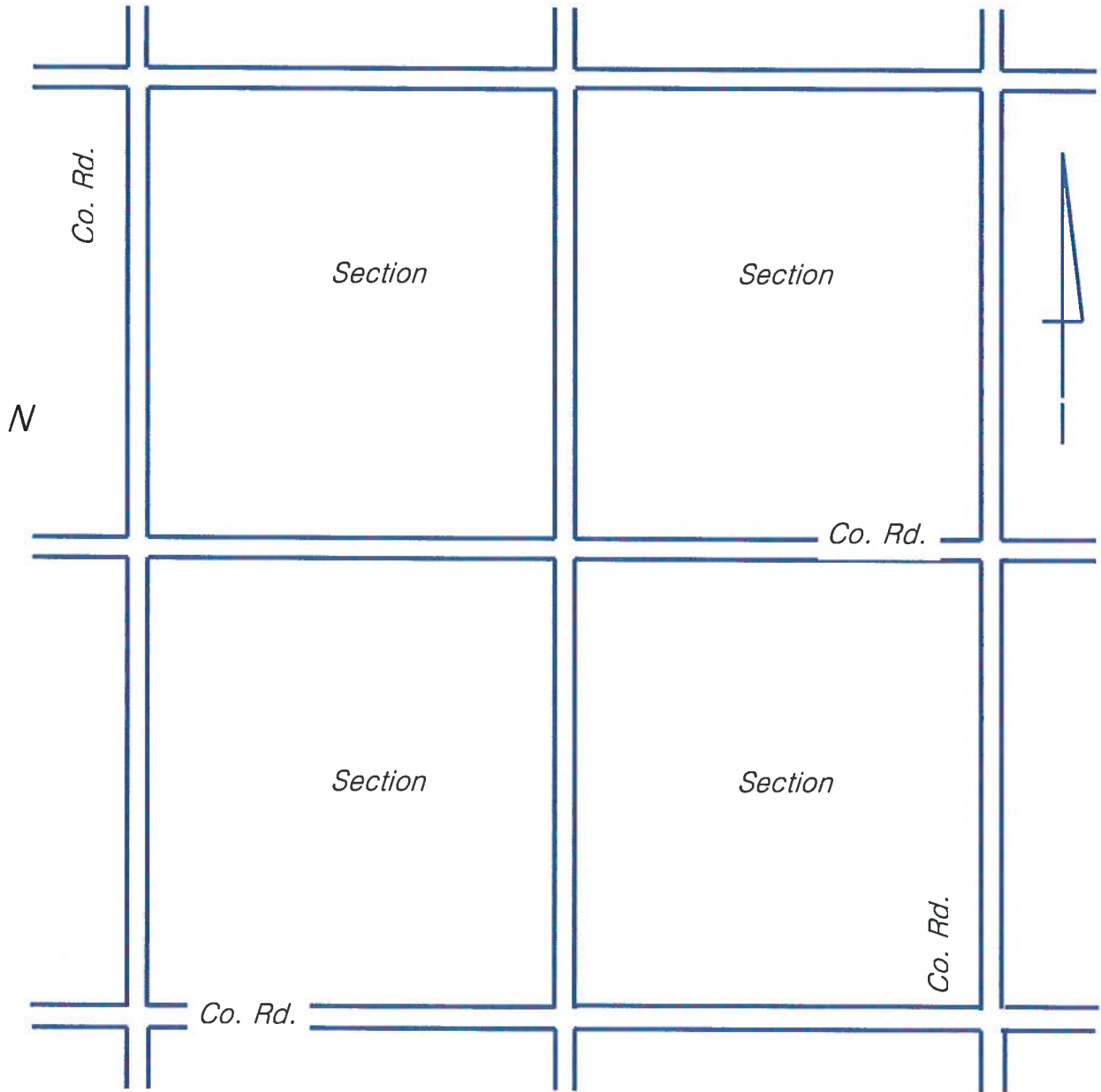

The crossing goes from Sec \_\_\_\_\_, T\_\_\_\_N, R\_\_\_\_W to Sec \_\_\_\_\_, T\_\_\_\_N, R\_\_\_\_W across County Road \_\_\_\_\_.

The crossing is \_\_\_\_\_ feet \_\_\_\_\_ (south, north, east or west) of \_\_\_\_\_  
 (Example: intersection of Co Rd 2 & 7, the  $\frac{1}{4}$  of Sec 5, the county bridge or my red barn)

The crossing is \_\_\_\_\_ (Example: 110V electric line, 3" water line, 4" sewer line, fiber optic line) which is buried \_\_\_\_\_ inches deep and \_\_\_\_\_ is not in a \_\_\_\_\_.(Example: conduit, culvert, pipe).

Show the crossing and any reference points on the diagram.

# PHILLIPS COUNTY COLORADO

## PLANNING & ZONING FEES

EFFECTIVE: JANUARY 8, 2020

Zoning Amendment: \$110 plus cost of advertising

Conditional Use Permit: \$110 plus cost of advertising

Subdivision Exemption: \$60 plus recording fees (\$13 for first page,  
\$5 each additional page – check made to Clerk)

Building Permit: \$45 plus the 1% use tax

Road Crossings: \$165 for boring under each dirt or gravel road.  
\$420 for trenching across each dirt or gravel road.  
( \$420 trenching refundable deposit will be collected.)  
\$125 for locally based utility companies.

Agricultural Use Permit Fees:  
(For Trenching or Boring)

There will be a \$120.00 fee for non-utility cuts  
(i.e. agricultural landowners who are required to cut  
county rights-of-way to provide utility services for  
agricultural production or a farm residence on their own  
property). Minimum depth is to be 48".

Right-of-way impacts: \$30 per mile for laying telephone lines in right-of-way **plus road crossing fee.**

Graduated fee per foot for burying pipelines in the right-of-  
way **plus road crossing fee.**

### Graduated Fees:

<u>Ditch Width</u>	<u>Cost per foot</u>
½" to 8"	\$0.20
8+ to 16	\$0.25
16+ to 24"	\$0.40
24+ to 42"	\$0.65
42+ "	\$0.75